

Straight Blade Devices
15A, 125V, 2 Pole, 3 Wire Grounding
Commercial Specification Grade Duplex
Receptacles

Features

- Triangle marking on face indicates isolated ground
- Smooth face
- Triple wipe contacts

Ordering Information

| Description | Device Color | UPC | Catalog Number |
|---|--------------|--------------|----------------|
| Isolated ground, smooth face, side wired only | Orange | 783585147550 | IG15CR |

Listings

UL Listed to UL498 File No. E2186
Certified to CSA C22.2, No. 42
Fed. Spec. W-C-596
NEMA® WD-6 Compliant

Specifications

| | |
|---------------------------------|------------------------------------|
| Face | Nylon |
| Base | Nylon |
| Power Contacts | .030 in. (.8) Brass |
| Ground Contacts | Brass |
| Wire Clamp | .062 in. (1.6) Nickel plated steel |
| Terminal Screws | Plated steel |
| Mounting Strap | .040 in. (1) Galvanized steel |
| Automatic Self-grounding Staple | Stainless steel |
| Mounting Screws | Galvanized Steel |

Performance

| | |
|-------------------------|--|
| Electrical | |
| Current Interrupting | Certified for current interrupting at full rated current |
| Dielectric Voltage | Withstands 2,000V minimum |
| Mechanical | |
| Product Identification | Ratings are a permanent part of the device |
| Terminal Accommodation | #14-#10 AWG copper stranded or solid conductor only |
| Terminal Identification | Terminals identified in accordance with UL 498 and CSA |
| Environmental | |
| Flammability | UL 94 V-2 |
| Operating Temperatures | Maximum continuous 75°C; minimum -40°C (w/o impact) |

HUBBELL

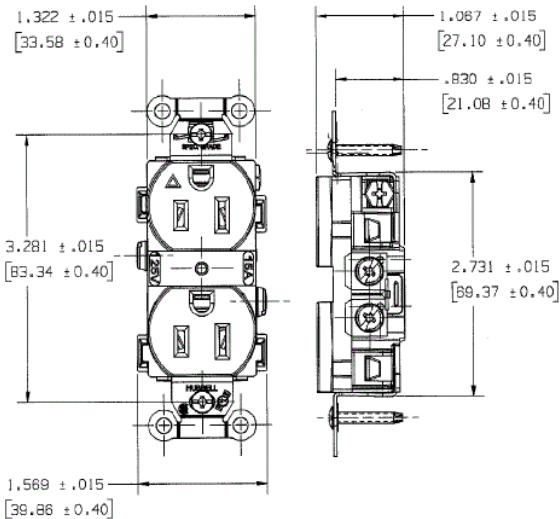

Accessories

Wallplate or Weatherproof Cover Duplex Opening

Resources

Customer Use Drawing
eCatalog



Features

- Reinforcement ribs for extra strength
- Captive screw feature holds mounting screw in place
- High-impact, self-extinguishing nylon material

Ordering Information

| Description | Color | Catalog Number | UPC |
|------------------------|--------|----------------|--------------|
| 1-Gang, Duplex Opening | Orange | NP8OR | 883778111112 |

Listings

UL Listed
CSA Certified

Specifications

| | |
|-----------------|-----------------------------|
| Plate Material | Nylon |
| Plate Type | 1-Gang |
| Plate Openings | Duplex Receptacle |
| Mounting Screws | Steel painted, slotted head |
| Appearance | Smooth |

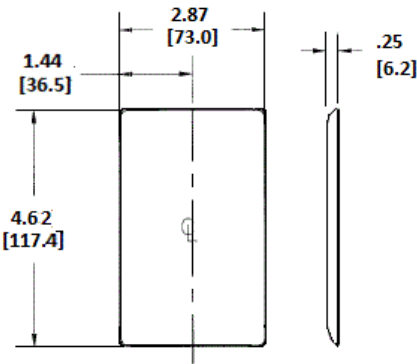

Online Resources

Customer Use Drawing
eCatalog